

## Forged Steel Globe Valves

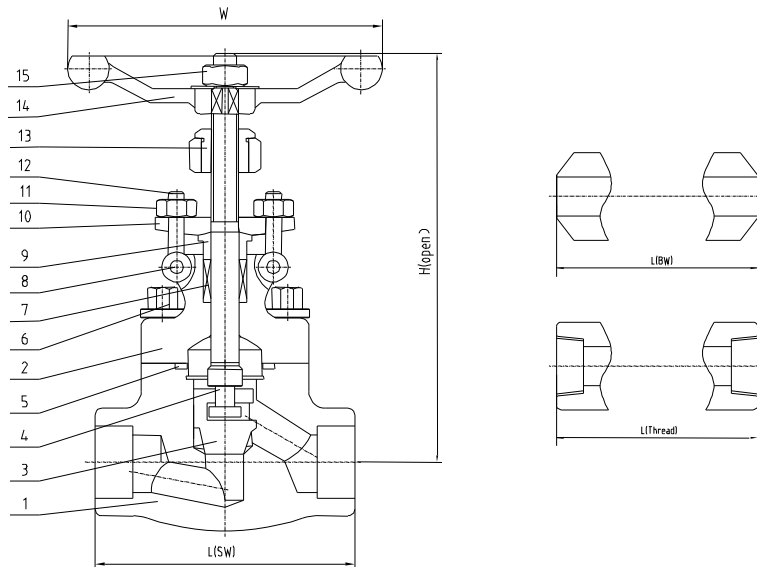

### Construction Features

OS&Y, Bolted or Welded Bonnet, Rising Stem

### Standards :

Basic Design: API 602

Threads End: ASME B1.20.1

Socket-Welding End: ASME B16.11

Butt-welding Ends: API 602

Inspection & Testing: API 598

### STANDARD MATERIAL SPECIFICATIONS

NO.	Name Parts	Material		
1	Body	A105	A182 F11/F22	A182 F304/F316
2	Bonnet	A105	A182 F11/F22	A182 F304/F316
3	Disc	A182 F6a	A182 F6a	A182 F304/F316
4	Stem	A182 F6a	A182 F6a	A182 F304/F316
5	Bonnet Gasket	Graphite+304/316, PTFE		
6	Bonnet Bolt	A193 B7	A193 B16	A193 B8
7	Stem Packing	Graphite/ PTFE		
8	Pin	A276 410	A276 410	A276 304
9	Gland	A276 410	A276 410	A276 304
10	Gland Flange	A105	A182 F11/F22	A182 F304/F316
11	Gland Nuts	A194 2H	A194 4	A194 8
12	Gland Eyebolts	A193 B7	A193 B16	A193 B8
13	Stem Nut	A276 410		
14	Hand wheel	Ductile Iron Or Steel		
15	Hand wheel Nut	CS		

### DIMENSIONS AND WEIGHTS

Class	NPS	3/8	1/2	3/4	1	1-1/4	1-1/2	2
800	L	76	76	86	102	140	140	170
	H(OPEN)	145	145	150	182	220	223	263
	W	90	90	90	110	150	150	150
	Weight(KG)	2	2	2.5	3.5	7	7	10.5
1500	L	90	90	104	120	150	150	180
	H(OPEN)	166	166	192	227	280	280	312
	W	90	90	110	150	150	180	180
	Weight(KG)	2.5	2.5	3	5.5	8.5	8.5	14.5